



# DIRECTIONS

for Operating

## COLEMAN Instant-Lighting LANTERN

No. 200A

## Filtering Funnel

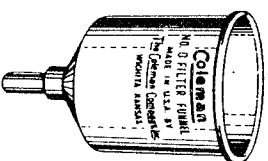

Most of the difficulty that users have with pressure gas lighting, heating, and cooking appliances is caused by dirty gasoline. Such a gas line quickly stops up the generators and gas tips with the result that the appliance does not operate properly. Gasoline accumulates dirt and impurities in handling; and also water which is condensed in the storage tanks. All this foreign substance can be removed when the gasoline is strained through the new Coleman Filtering Funnel.

The No. 0 Funnel is well made of good material and has in the bottom a removable ring covered with a special filter fabric. When this fabric becomes saturated with gasoline, neither water nor dirt will pass through it. It is removable and can be cleaned by rinsing in fresh gasoline. Funnels are furnished in two sizes:

No. 0 - Filtering Funnel, complete - Extra Pad for No. 0 Funnel

No. 1A - Filtering Funnel, complete - Extra Pad for No. 1A Funnel

Listed below are the dimensions and capacity per minute of these two funnels.

No.	Diameter	Height	Outlet	Capacity per Min.
0	2 1/4 in.	3 1/2 in.	3/8 in.	1/2 Gal.
1	5 in.	6 in.	1/4 in.	4 Gals.

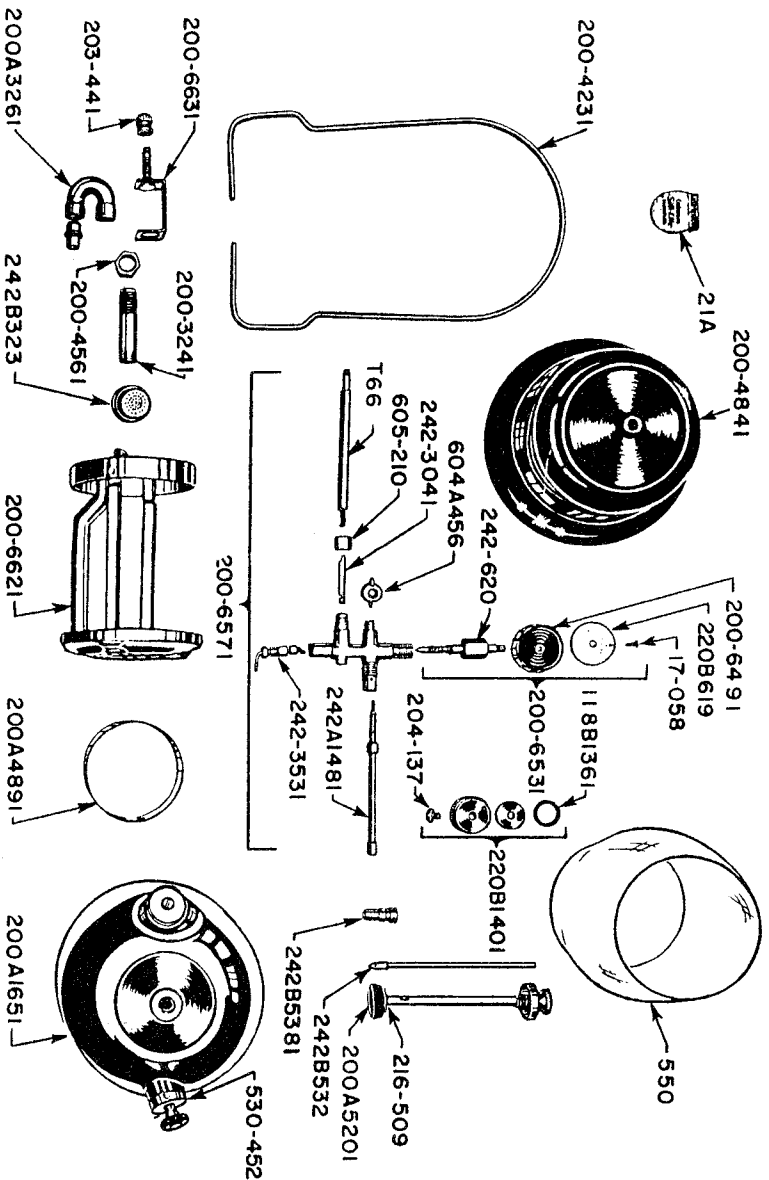

## Parts List for COLEMAN LANTERN No. 200A

Order by Number	Name of Part	Order by Number	Name of Part
17 - 58	Machine Screw	200A489	Base Rest
690A051 (550)	Pyrex Globe	200A5201	Pump Plunger Complete
021A306 (21A)	Mantle	220B1401	Filler Plug Complete
118B1361	Filler Plug Gasket	220B619	Direction Disc
200 - 3241	Burner Tube	203 - 441	Ventilator Ball Nut
200 - 370	Frame and Burner Complete	204 - 137	Screw for Filler Plug
200 - 4231	Ball	242 - 238	Generator Needle
200 - 4561	Lock Nut	242 - 299 (T66)	Generator
200 - 484	Ventilator	242 - 3041	Eccentric Block
200 - 6491	Valve Wheel	242 - 3531	Tip Cleaner
200 - 6531	Valve Stem with Wheel	242 - 620	Packing
200 - 6571	Fuel Valve Complete	242A1481	Fuel and Air Wire Complete
200 - 6621	Burner Frame Assembly	242B532	Burner Cap and Screen
200 - 6631	Ventilator Bracket	242B5381	Pump Air Stem
200A1651	Font	530 - 452	Check Valve
200A3261	"U" Tube	604A456	Pump Cap Screws
200A328	Ventura	605 - 210	Hexagon Brass Nut
			Jamb Nut

## The Coleman Company, Inc.

General Office and Factory: WICHITA 1, KANSAS, U. S. A.  
 Canadian Office and Factory: Toronto, Canada  
 Sales Offices: Philadelphia 8; San Francisco 3; Los Angeles 1;  
 Honolulu, Hawaii

F144B

LITHO IN U. S. A.



# SAVE THIS SHEET FOR FUTURE REFERENCE

## How To Operate Your No. 200A Lantern

### Always Use the Right Kind of Fuel

Use substances in gasoline which do not vaporize and collect in the generator in the form of carbon. The amount of service obtained from a generator depends, to a great extent, upon the kind of fuel used.

Always use clean, fresh, unleaded gasoline. Never use a gasoline containing lead compounds or lubricating oils. Keep gasoline supply in a small, cleaned metal can. Do not use a glass container because of hazard in case of breakage. Gasoline exposed to light will sour in a short time.

A suitable unleaded fuel is not available, then ask your service station operator to inquire of his company. Most oil companies make available a special stove and lighting fuel or naphtha for use in those localities where a suitable white gasoline is not available.

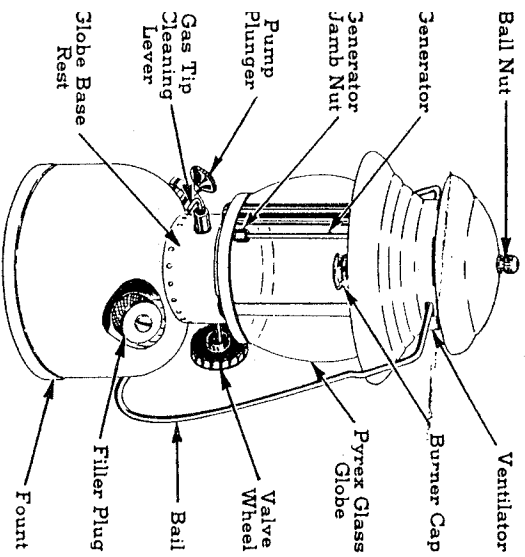

**To Fill:**  
Be sure Fuel Valve is tightly closed by turning Valve Wheel to right. Remove Filler Plug and fill Fount with fresh, clean, untreated gasoline. Do not tip lantern while filling. Always let it set flat on its base. We suggest the use of the Coleman Filtering Funnel for straining the gasoline. Your dealer can supply you. Fill fount—it holds 1 3/5 pints—then replace Filler Plug and tighten firmly with fingers.

### 2. To Pump Air Pressure Into Fount:

See that Fuel Valve is closed. Then open Air Check Valve inside of Pump Barrel by turning Pump Plunger two full turns to left. Place ball of thumb over small hole in end of Pump Plunger and pump 20 to 30 full strokes of air into Fount. Now, turn Pump Plunger to right until tight.

### 3. To Attach Mantle:

Unscrew Ball Nut from top of Lantern. Pull Ball out of Bail Sockets, remove Ventilator and Pyrex Glass Globe. Tie Mantle to groove in Burner Cap with flat side of Mantle parallel to Generator.

Distribute folds of Mantle evenly at top and cut off surplus string. Then burn off Mantle following directions on Mantle envelope. Allow Mantle to cool several minutes before lighting lantern. Replace Pyrex Glass Globe, Ventilator and Ball. Be sure Ball is engaged in Bail Sockets. Then replace Ball Nut.

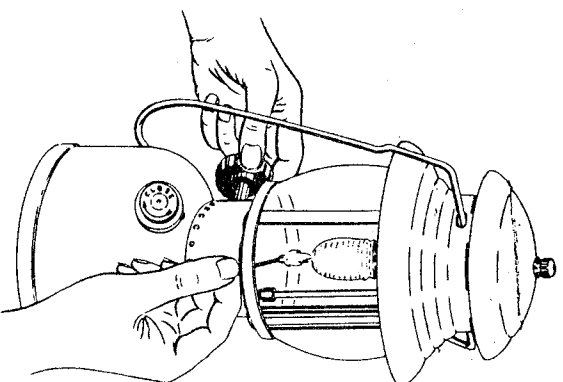

### 4. To Light:

(a) Rotate several times the Gas Tip Cleaning Lever which extends from under the Lantern Frame. This forces the point of the Cleaning Needle in and out of the Orifice in the Gas Tip at the end of the Generator to dislodge any

particles of carbon which may have collected in the Orifice. The Lever should be left pointing down.

(b) Have a match ready to light. Now, OPEN THE FUEL VALVE ONE-FOURTH TURN ONLY. Light the match, insert it through the lighter opening and hold it under the Mantle as shown in the illustration. A few seconds time may elapse before you will hear the mixture of gas and air feeding into the mantle but at that time the Mantle will light instantly. The light may flicker somewhat for a few seconds but as soon as Mantle burns bright open the Valve as far as possible. Unless you open the Valve all the way after the lantern has been properly instant-lighted air pressure will continue to escape through the Valve and Generator.

### 5. To Turn Out Light:

Turn Fuel Valve to right until closed. The light will dim and go out in a few seconds.

### 6. To Change Generator:

Remove Ventilator and Pyrex Globe. Unscrew hexagon nut No. 6044A456 which holds Burner and Frame to Lantern. Carefully lift Burner and Frame up over Generator to avoid damage to the Mantle.

Turn Gas Tip Cleaning Lever up. Unscrew Generator Jamb Nut at lower end of Generator. Lift Generator up and unhook Gas Tip Cleaning Needle.

Pull end of Cleaning Needle down out of the new Generator far enough to hook into hole in Eccentric Block. After hooking Needle to Eccentric Block turn Gas Tip Cleaning Lever down. Next, slide Jamb Nut down over Generator and tighten with only enough force to prevent a leak at that point.

Be careful when placing Burner and Frame down over generator so Mantle will not be damaged. Replace and tighten hexagon nut to hold Frame and Burner in place.

### 7. Keep Fount Clean:

Rinse the Fount occasionally in order to prevent an excessive accumulation of sediment or moisture in the Fount. Contents of the Fount may be poured out through the Filler Plug Bushing.

### 8. Keep Burner Parts Clean:

Each time before installing a new Mantle use a bristle brush, such as a discarded tooth brush, to clean the Screen in the Burner Cap.

**THE PUMP PLUNGER** is not only used for pumping air pressure into the Fount but it acts as a wrench to turn the Air Stem. Turning the Plunger to the left unscrews the Air Stem so that air may be forced through the Check Valve at the bottom of the Pump Barrel. Turning the Pump Plunger to the right screws the Air Stem into the Check Valve to provide a positive shut-off at that point. Air pressure may be added while Lantern is burning. Oil the leather occasionally for greater efficiency.

**IF LANTERN IS TO BE LEFT UNUSED** for several days or weeks, it would be well to empty the gasoline from the Fount. This would prevent the gasoline from souring and forming gum in the Fount.

**TO TEST BUILT-IN PUMP** for an air pressure leak, tip the Fount over so you can hold end of Pump in a full glass of water.

## SUGGESTIONS

About Care and Use of Coleman Instant-Lighting Lantern No. 200A

**A. If Lantern Does Not Light,** make sure there is plenty of air pressure and gasoline in Fount. Remove Generator Gas Tip to make sure that point of Needle has not been bent or curled. Open Valve slightly to make sure raw gasoline will come through Generator.

**B. If Mantle Turns Black,** make sure Screen in Burner Cap is clean and open. Check Air Intake Tube for a possible obstruction such as a spider's nest.

**C. If Light Grows Dim,** perhaps Valve has not been opened all the way after Lantern has been instant-lighted. Rotate Cleaning Lever on side of Valve to remove carbon, if any, from Orifice in Generator Gas Tip.

**D. If You Have Occasion To Write** the dealer or the factory, mention the model number of your Lantern.

**E. If You Have To Mail Lantern In For Service Attention,** then send it less the Pyrex Globe and Ventilator to avoid breakage.